

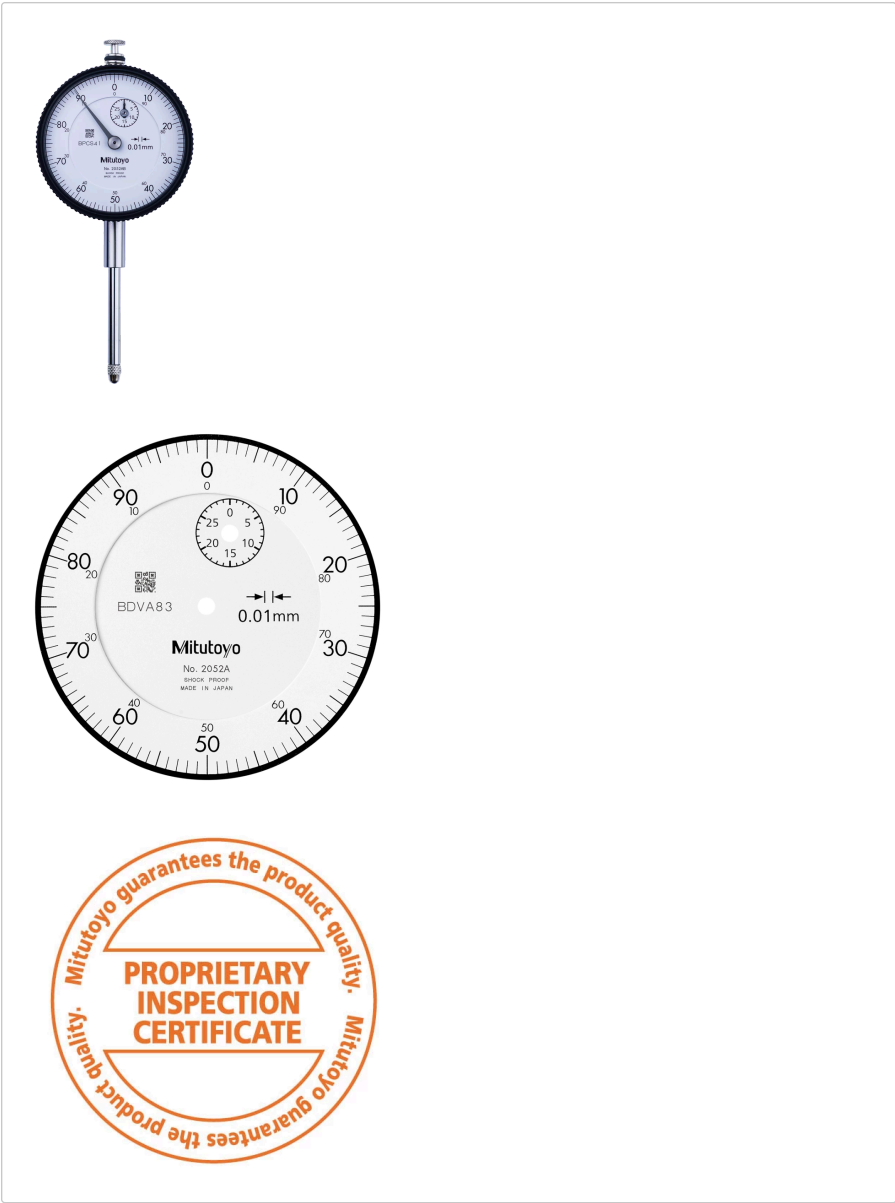

# Dial Gauge, Lug Back, ISO Type

Item number: 2052A

## Images



## Description

**Standard Type, 30 mm Range, 0,01 mm Graduation**

This is a standard dial indicator. It offers you the following benefits:

- Bezel clamp and lifting lever (optional) can be attached to either right or left side. They can be easily installed and removed without tools.
- No through screw holes on the frame and secure adhesion between the bezel and the crystal as well as the use of an O-ring prevents water or oil penetration.

## Specification

Digital/Analog:	Analog
Inch-Metric:	Metric

<b>Type:</b>	EN ISO Standard
<b>Delivered:</b>	With certificate of inspection
<b>Range:</b>	30 mm
<b>Range per rev.:</b>	1 mm
<b>Dial reading:</b>	±0.0-100.0
<b>Graduation:</b>	0.01 mm
<b>MPE any 1/10 revolution:</b>	7 µm
<b>MPE any 1/2 revolution:</b>	11 µm
<b>MPE any 1 revolution:</b>	12 µm
<b>MPE measuring range:</b>	25 µm
<b>H MPE (Hysteresis):</b>	5 µm
<b>R MPE (Repeatability):</b>	3.0 µm
<b>Measuring force:</b>	0,4-2,5 N
<b>Mass:</b>	152 g
<b>Stem:</b>	8.0 mm
<b>Contact point:</b>	Carbide tipped, thread: M 2.5 x 0.45 mm
<b>Continuous dial:</b>	Yes
<b>Cushioned end point:</b>	Yes

## Dimensions

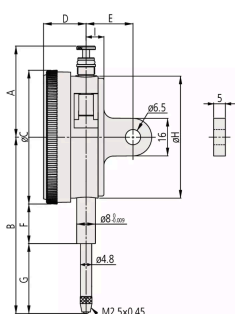

**A:** 38.5 mm  
**B:** 88.7 mm  
**C:** 57 mm  
**D:** 18.1 mm  
**E:** 20 mm  
**F:** 16.9 mm  
**G:** 43.3 mm  
**H:** 52 mm  
**I:** 7.6 mm

## Accessories

Optional accessories:



### Limit Hands (green) 2pcs

Dial Indicator Series 2/3/4  
Art No. 21AZB195



### Bezel Clamp for Dial Gauge

Metric, Series 2/3/4  
Art No. 21AZB148

#### Spare parts

##### Consumable spares:



### Contact Element Ball Point, M2,5x0,45

7,3mm Length, Carbide, Metric  
Art No. 901312  
**£7.70** ex. VAT